

# OFFICE/ MEDICAL CONDOS FOR SALE OR LEASE

[www.NECCommercial.com](http://www.NECCommercial.com)



1700-1721 HERITAGE HILLS DR.  
WASHINGTON, MO 63090

- Suites Available from 1,150 sf to 13,800 sf
- Building completely renovated 2017
- Excellent location with signalized access to Hwys 100 & 47
- New Pylon Signage available
- Professional office park setting with covered entrances and courtyard access
- Ample parking
- Suites can be combined to various sizes

Lease Rate: \$11NNN

Sale price:\$115psf

Joseph Bosse  
(636) 271-1128  
[jbosse@neccommercial.com](mailto:jbosse@neccommercial.com)



# FLOOR PLAN

1700-1721 HERITAGE HILLS DR., WASHINGTON, MO 63090

[www.NECCommercial.com](http://www.NECCommercial.com)

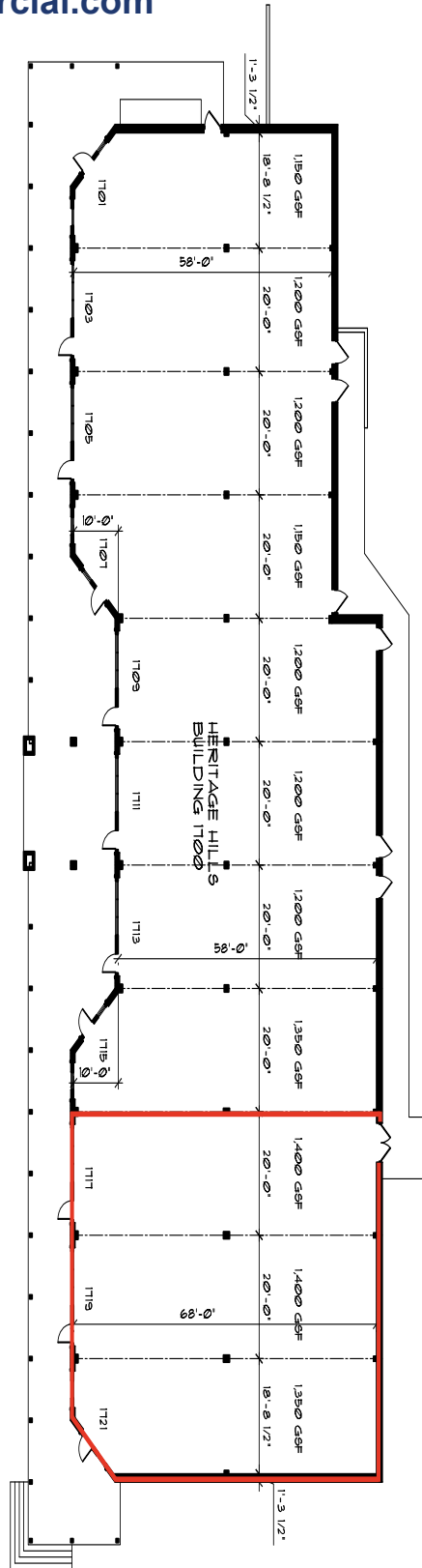

**Medical Suite  
4,150sf**

**FLOOR PLAN**  
SCALE: 1/8" = 1'-0"  
0' 4' 8' 16' 32'

BUILDING # 1100  
HERITAGE HILLS DEVELOPMENT  
WASHINGTON, MISSOURI 63090

**HORN ARCHITECTS**  
314 S. 11TH ST. SUITE 200  
ST. LOUIS, MO 63102  
TEL: 314.433.8888  
WWW.HORNARCHITECTS.COM



Contact:  
Joseph Bosse  
(636) 271-1128  
[jbosse@neccommercial.com](mailto:jbosse@neccommercial.com)